

BRK Brands, Inc., ("BRK") warrants that for a period of five (5) years from the date of purchase, this product will be free from defects in material and workmanship. BRK, at its sole option, will repair or replace this product or any component of the product found to be defective during the warranty period. Replacement or repair will be made with a new or remanufactured product or component. If the product is no longer available, replacement may be made with a similar product of equal or greater value. This is your exclusive warranty.

This warranty is only valid for the original retail purchaser from the date of initial retail purchase and is not transferable. You must keep the original sales receipt. Proof of purchase is required to obtain warranty performance. BRK dealers, service centers, or retail stores selling this product do not have the right to alter, modify or in any way change the terms and conditions of this warranty.

This warranty does not apply to the finish on the product. This warranty does not cover normal wear and tear of parts or damage resulting from any of the following: negligent use or misuse of the product, use contrary to the operating instructions, disassembly, repair or alteration by anyone other than BRK or an authorized service center, improper installation, or exposure to extremes of heat or humidity. Further, the warranty does not cover Acts of God, such as fire, flood, hurricanes and tornadoes.

BRK shall not be liable for any incidental or consequential damages caused by the breach of any express or implied warranty. BRK is also not responsible for: costs associated with removing or installing the product; damage or loss of the contents of the product; nor for the unauthorized removal of the contents; or damages incurred during shipment.

Except to the extent prohibited by applicable law, any implied warranty of merchantability or fitness for a particular purpose is limited in duration to the duration of the above Warranty Period. Some states, provinces or jurisdictions do not allow the exclusion or limitation of incidental or consequential damages or limitations on how long an implied warranty lasts, so the above limitations or exclusion may not apply to you. This warranty gives you specific legal rights, and you may also have other rights that vary from state to state, or province to province, or jurisdiction to jurisdiction.

Operation & Installation Guide

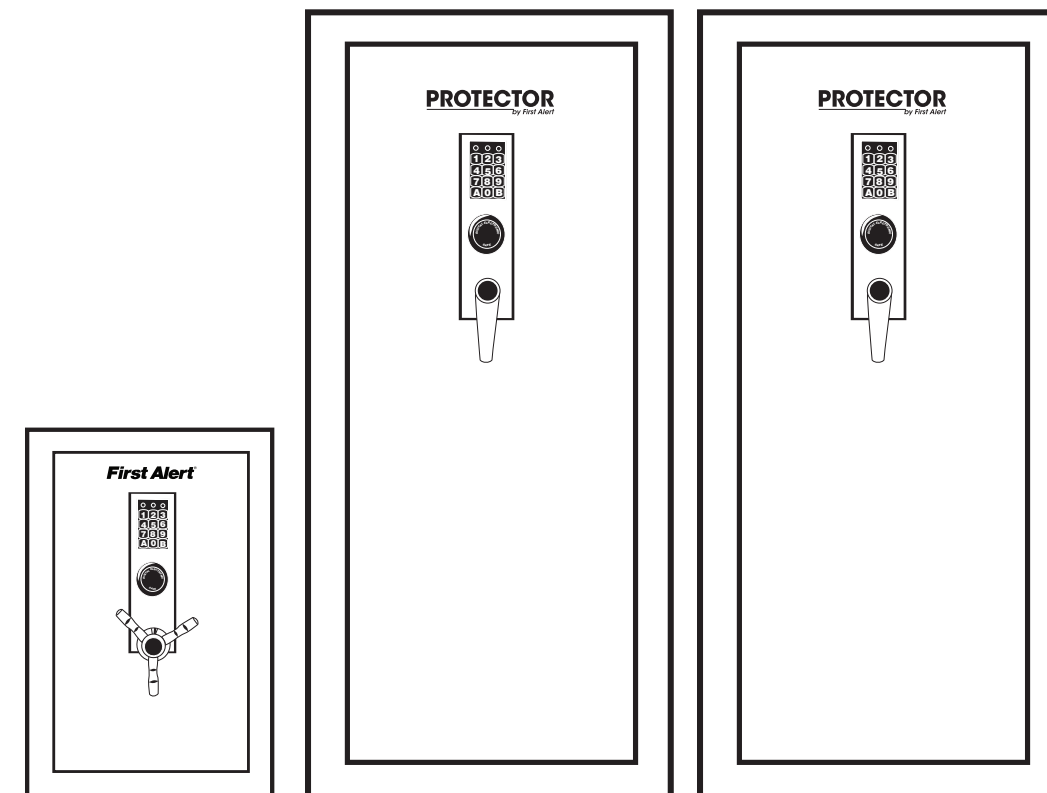

EXECUTIVE SAFE

If you have any questions that cannot be answered by reading this manual, call Consumer Affairs at 1-800-323-9005

© 2010 BRK Brands, Inc., a Jarden Corporation company (NYSE: JAH)
3901 Liberty Street Road, Aurora, IL 60504-8122
All rights reserved.

www.FirstAlert.com

Models 2484DF / 6741DF / 6742DF

- Read carefully
- Keep for reference
- Do not keep inside of safe

2484DF

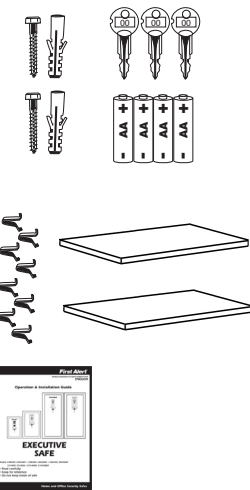
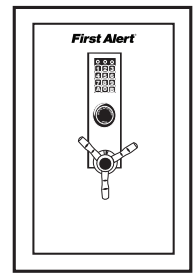

6741DF

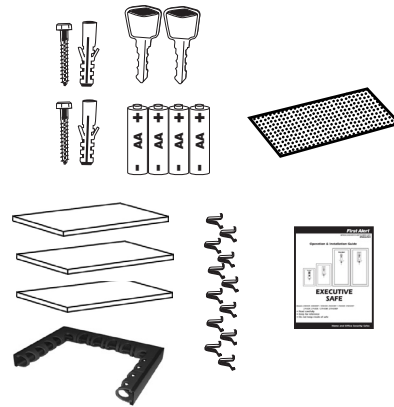
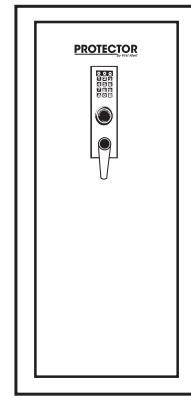

6742DF

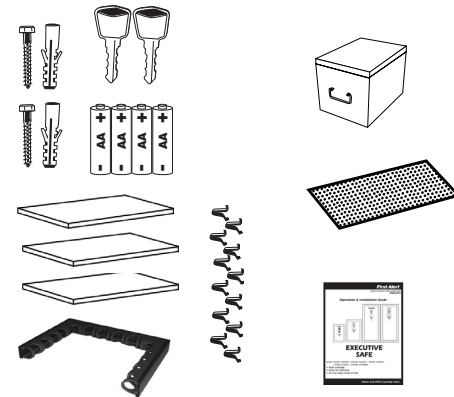
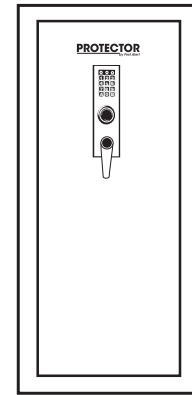

Appropriate use of your safe

This Executive Safe protects records and many other valuables.

Testing shows that the interior temperature of the safe remains below 350°F (177°C) for 30 minutes during a fire up to 1100°F (593°C) when used properly. Your safe must be closed and latched in order to properly protect the contents from fire.

Important:

Because pearls sustain heat damage at temperatures below 350° F, we advise that you store pearls in this safe.

Safe Care and Maintenance

When properly maintained, your safe will continue to operate and accurately read the authorized Passcode for many years. In order to ensure optimum performance of your safe, please follow these simple precautions:

- For best results and performance, we recommend that the batteries be replaced at least once a year or sooner depending on amount of use.
- Never attempt to operate the digital keypad if your hands have excessive dirt, debris or liquids on them.
- To clean the surface of your safe, it is recommended that you use a mild cleaner (e.g., window cleaner) to avoid scratching or discoloring the surface. Always wipe dry and NEVER use abrasive cleansers on the safe or digital keypad.
- We recommend that you place delicate items such as pictures or intricate jewelry into an air-tight container before storing them in your safe. Avoid placing your safe in areas of high humidity. For optimum performance, the safe should be opened and aired out for at least 20 minutes every two weeks.

For future reference, store this Operation and Installation Guide in a secure area away from the safe. **DO NOT DISCARD!** If service is required, do not return the product to your retailer. In order to obtain warranty service, contact the Consumer Affairs Division at 1-800-323-9005, 7:30 am – 5:00 pm Central Standard Time, Monday through Friday. To assist us in serving you, please have the model number and date of purchase available when calling.

Safe Identification Record

Model Number _____ 1
 Serial Number _____ 2
 Key Number _____ 3

Digital Passcode Record

Model 2484DF / 6741DF / 6742DF

Your Passcode must be at least 3 digits and no more than 8 digits followed by the letter A or B.

									A
									B

2484DF
6741DF
6742DF

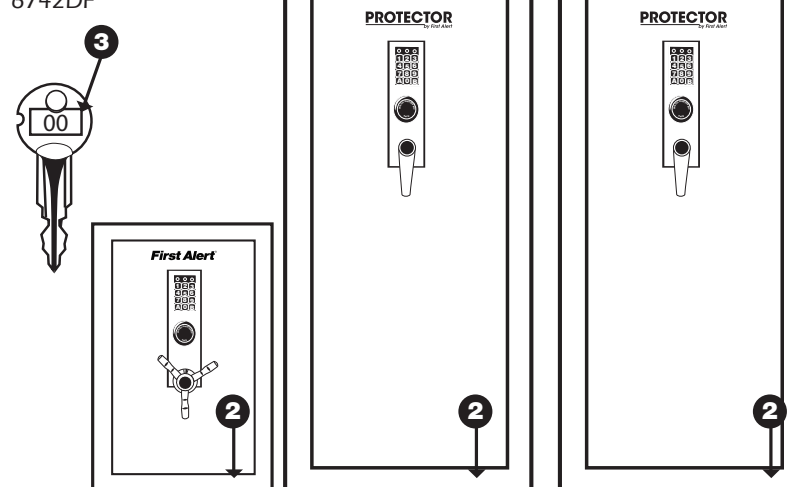

Important: DO NOT RETURN SAFE TO STORE

If you are missing parts, have difficulty programming your safe or have any other questions pertaining to its proper use and care, DO NOT RETURN your safe to the store. Please contact Consumer Affairs at 1-800-323-9005, 7:30 am – 5:00 pm Central Standard Time, Monday through Friday. To assist us in serving you, please have the model number and date of purchase available when calling.

First Alert, Inc.,
 Attn: Warranty Safe Returns
 23610 So. Banning Blvd.
 Carson, CA 90745

If you lose or forget the combination or lose the safe key, you can obtain a copy of the combination or a replacement key from BRK Brands, Inc. You must supply the following information to assure accurate processing:

- Name / Address / Telephone.
- Safe Model Number / Serial Number.
- Key Number (located on the key and on the Emergency Override Key lock).
- Notarized statement of ownership.
- For replacement keys, indicate number of keys requested. Please ignore if recovering a lost combination.
- Method for how you would like to receive the combination or keys.

Please send all the information via fax at 630-851-7995 or mail BRK Brands, Inc., 3901 Liberty Street Road, Aurora, IL 60504-8122

Checks or Money Orders are required for orders received by mail and should be made payable to First Alert. Contact our Consumer Affairs Department for costing information prior to ordering.

First Alert
 Consumer Affairs
 3901 Liberty St Rd
 Aurora, IL 60504

Shelf install

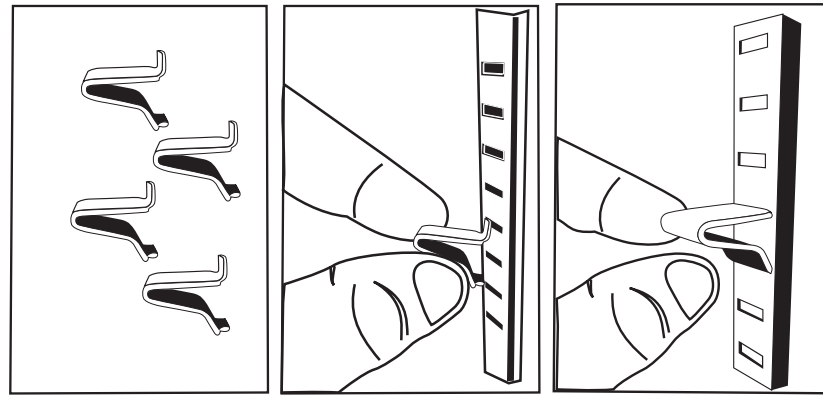

6741DF, 6742DF

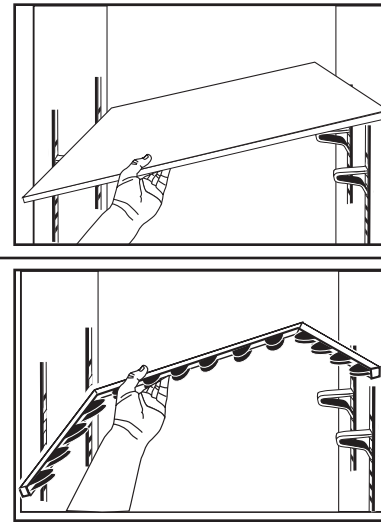

Floor mounting

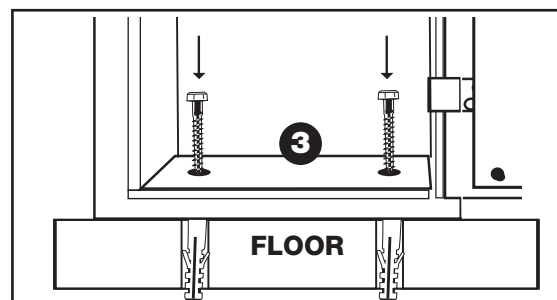
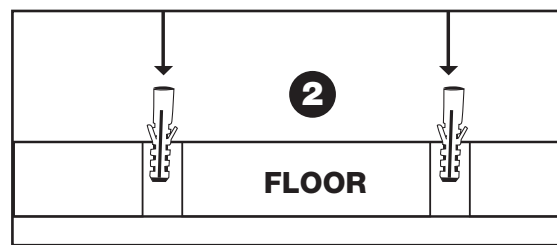
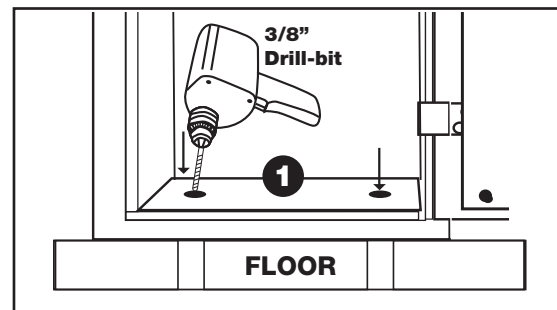

Wall mounting

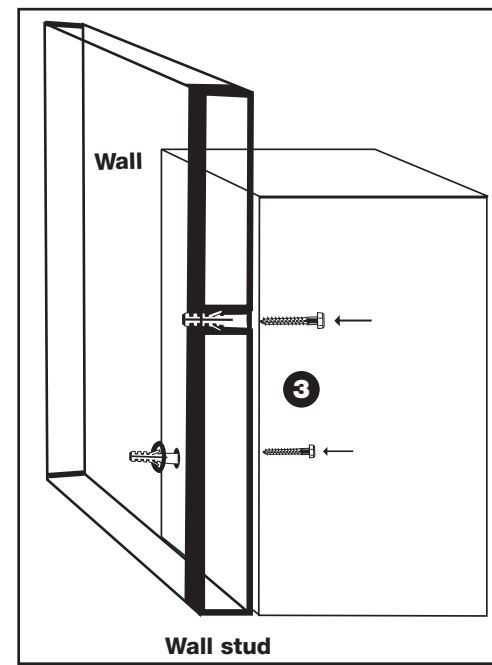
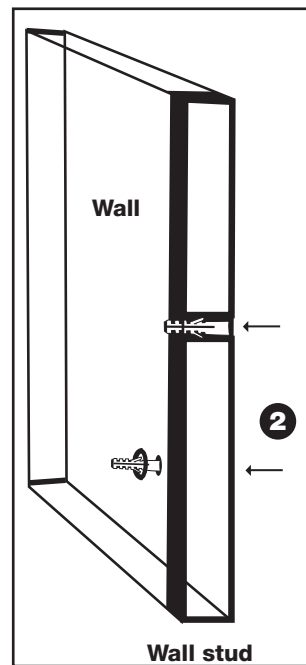
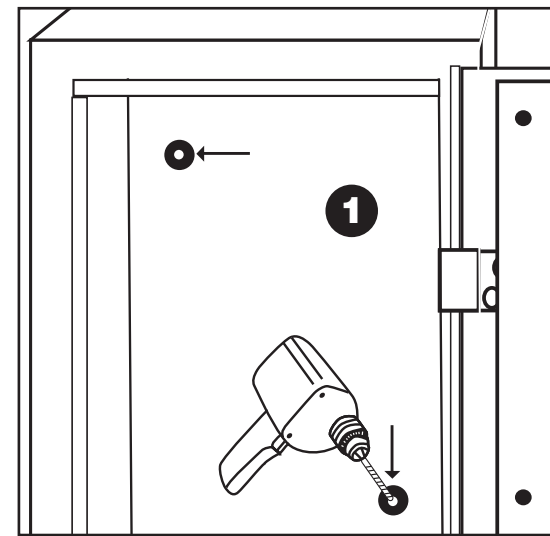

Override key use

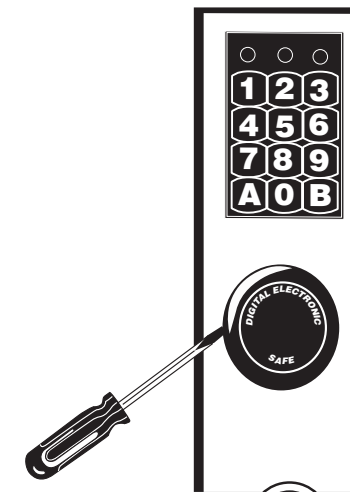

Remove override key lock cover

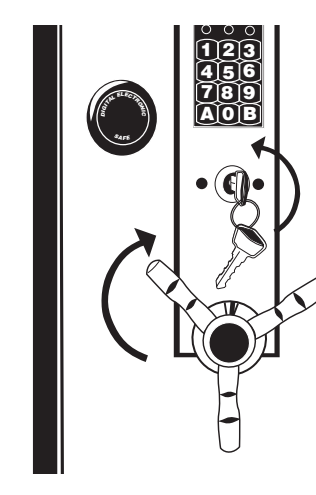

Insert key and turn counterclockwise and hold. Rotate handle clockwise then pull door open

6741DF / 6742DF

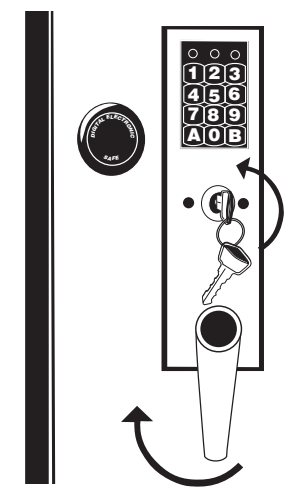

Important:

If the handle will not rotate clockwise after the key is turned, then rotate the handle slightly counterclockwise until it stops, then rotate clockwise again to open.

Important:

The override key is used to gain access to the safe to change batteries or if the digital lock fails to operate. This key should be stored in a secure place away from your safe.

Battery install

Press the "B" key. If lights flash red or no lights then replace batteries. If lights flash yellow batteries are ok.

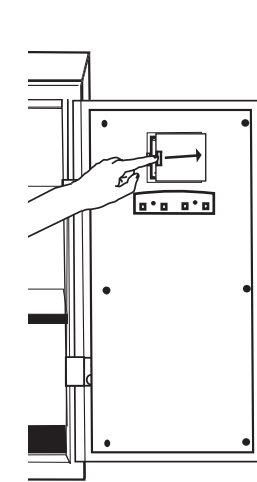

Remove battery cover

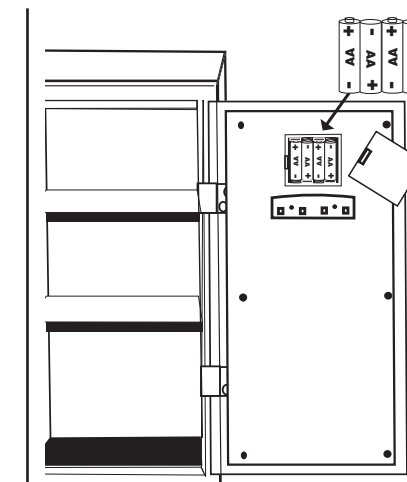

Install 4 "AA" batteries in the correct direction

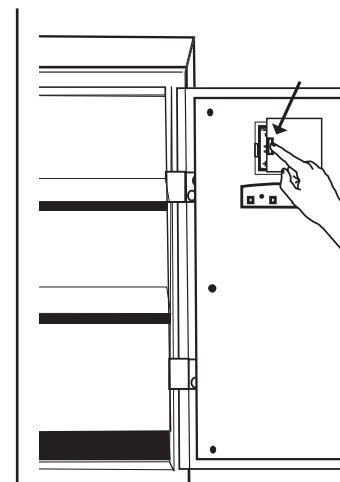

Replace battery cover

If installed correctly:

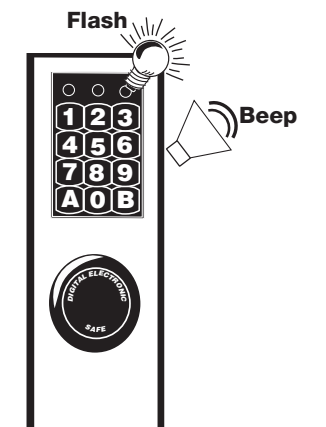

Red light flashes followed by audible beep

Programming Personal Passcode

Closing safe

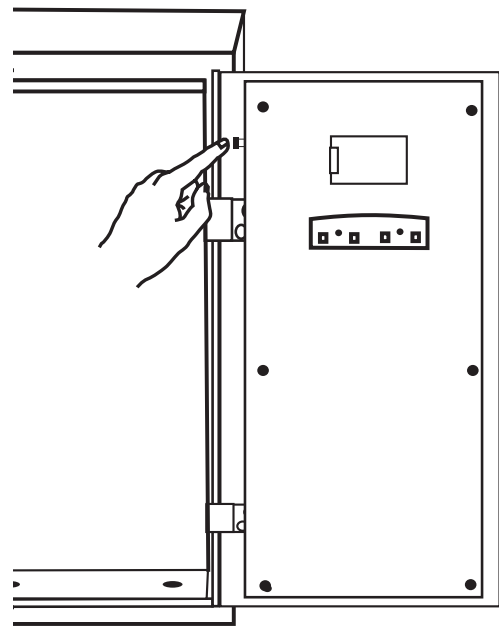

Press reset button

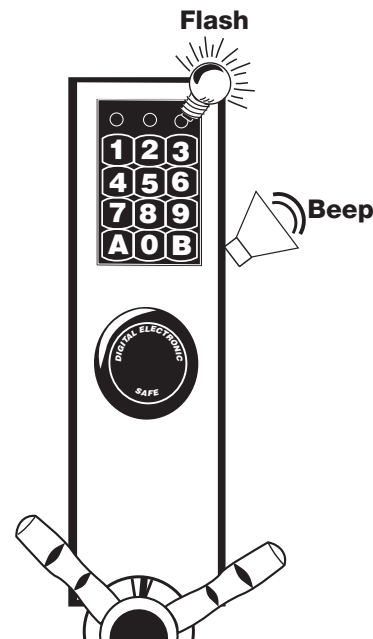

Ready light flashes along with a beep

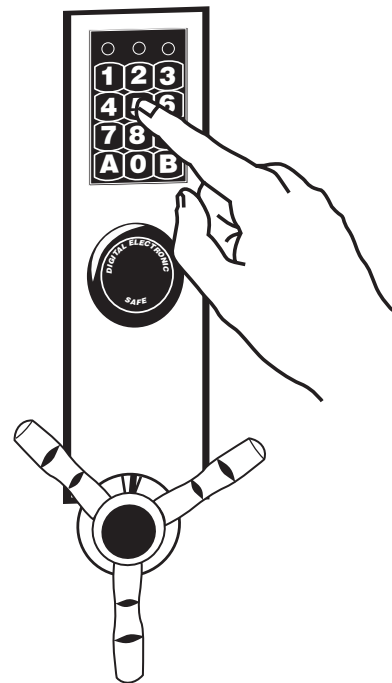

Enter new code: 3-8 digits followed by the "A" or "B" key

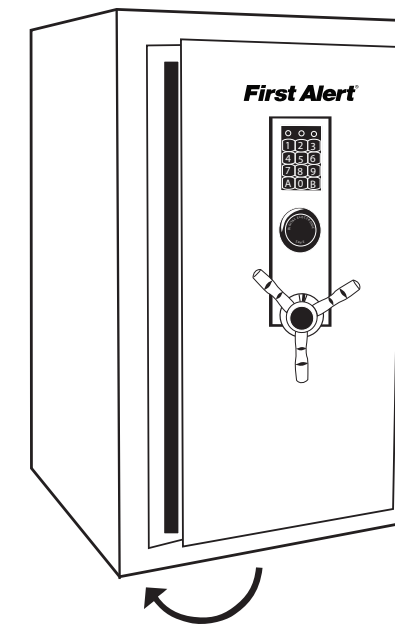

Push door closed then rotate handle counterclockwise fully into the locked position.

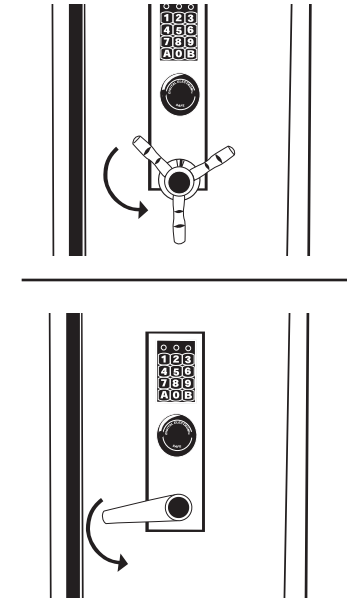

TROUBLE SHOOTING:

If safe fails to open with your Personal Passcode, try the following:

1. Check to see if the batteries have been installed properly and replace if necessary.
2. Lock-out may have occurred. Wait 15 minutes before trying again.
3. Contact BRK Consumer Affairs Department.

Personal Passcode entry

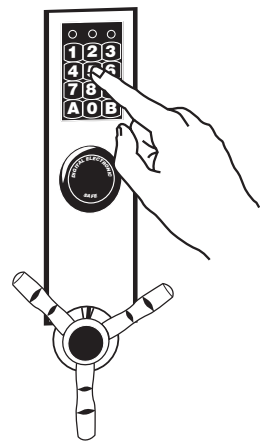

Enter new Personal Code + A or B

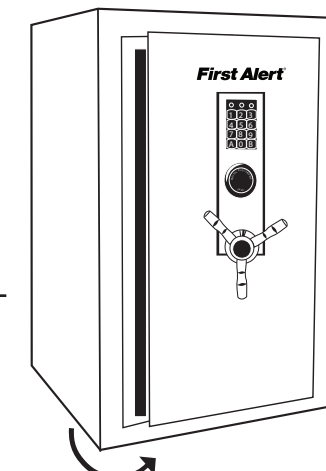
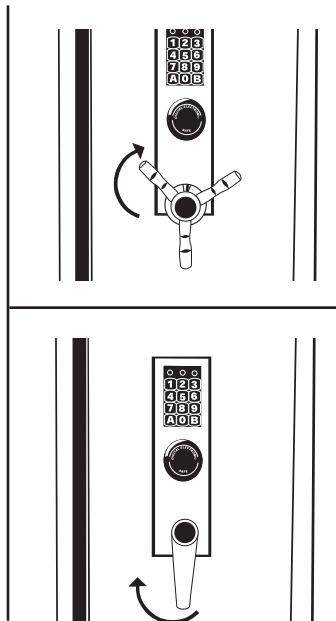

Rotate handle clockwise then pull door open

SECURITY LOCK-OUT PERIODS:

For added security, the safe will automatically "Lock-out" entry for 15 minutes after three attempts to open with an invalid Passcode.

NOTES

Important: If the handle will not turn

If the handle will not turn to the right after the green light comes on, first turn the handle slightly back to the left until it stops, then turn upwards to the right again to open